

Leviathan Garden Bar

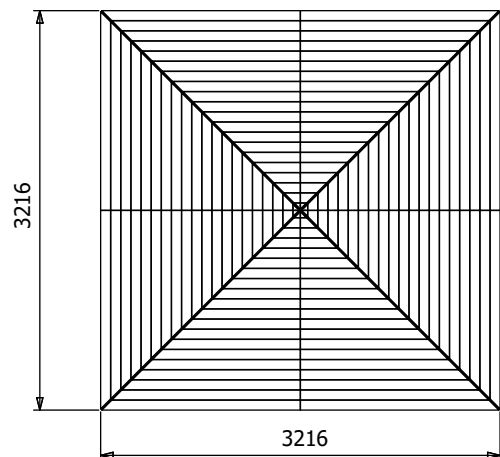
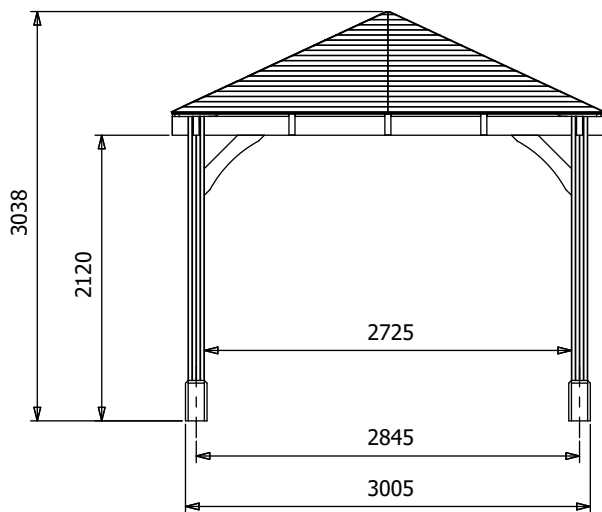
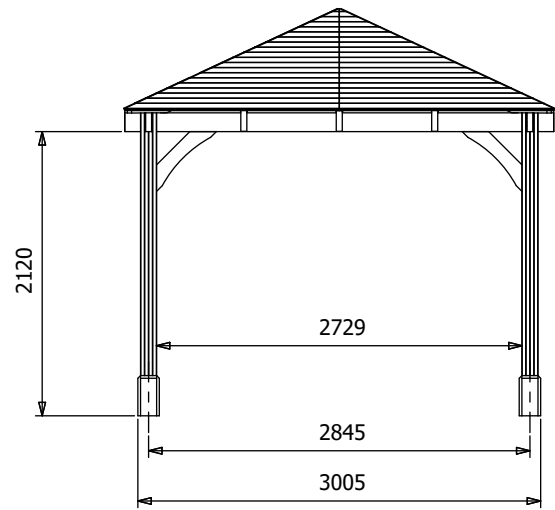

Specification

Image shows base product as an example and excludes any wall configurations.

- **Overall External Dimensions:** 3.22m x 3.22m (10' 6" x 10' 6")
- **External Width:** 3.20m (10' 5")
- **External Depth:** 3.20m (10' 5")
- **Internal Width (Post):** 2.73m (8' 11")
- **Internal Depth (Post):** 2.73m (8' 11")
- **Ridge Height:** 3.04m (9' 11")
- **Eaves Height:** 2.12m (6' 11")
- **Timber:** Spruce
- **Uprights:** 120mm x 120mm
- **Roof:** 19mm Tongue and Groove Boards
- **Roof Covering Options:** None, Felt or Shingles

- **Guarantee:** 10 Years on Pressure Treated Timber against Rot and Insect Infestation
 - **Please Note:** All fixings needed for assembly are supplied
 - **Approx. Assembly Time:** 1 Day*
- *This is an approximate time only, based on 2 people. Assembly time may vary depending on season/weather conditions, foundation type, ability of those constructing, etc