

Addroom Garden Room Grooved Effect W3.0m x D3.0m

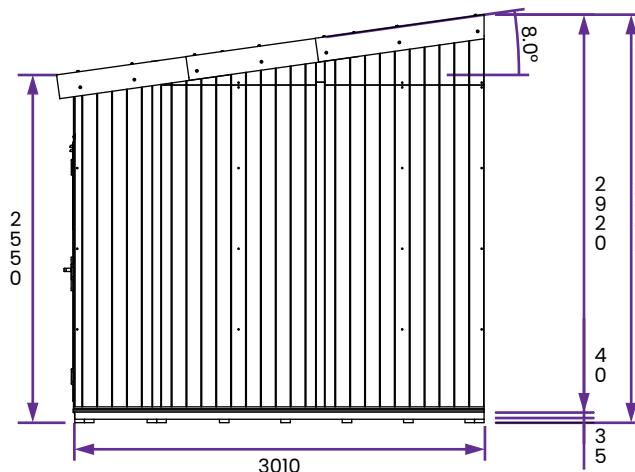
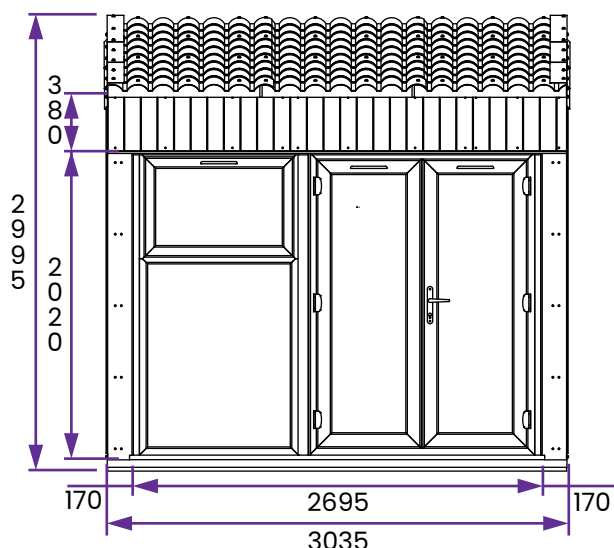
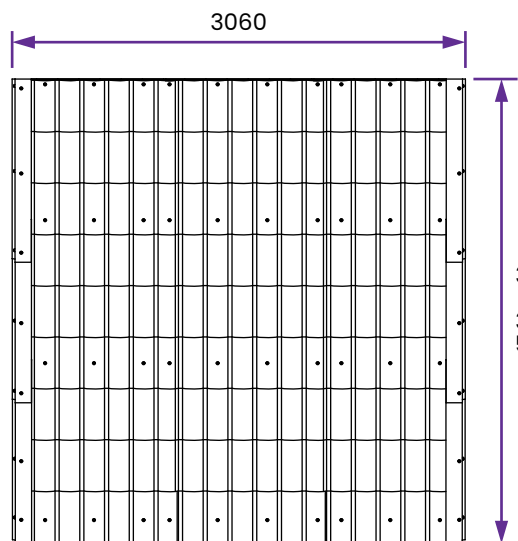

Specification

- **Overall External Dimensions:** 3.06m x 3.13m (10' 0" x 10' 3")
- **External Width:** 3.01m (9' 10")
- **External Depth:** 3.01m (9' 10")
- **Internal Width:** 2.73m (8' 11")
- **Internal Depth:** 2.92m (9' 6")
- **Internal Area(m²):** 8.01m²
- **Ridge Height:** 2.99m (9' 9")
- **Internal Eaves Height:** 2.41m (7' 11")
- **Wall Thickness:** 140mm Insulated Panels Consisting of: 10mm WPC (Wood Polymer Composite) Outer Wall, PIR 25mm, 70mm Timber Frame, PIR 25mm and 10mm Fermacell

- **Floor Thickness:** 40mm Insulated Sandwich Panel
- **Floor Bearers:** Pressure Treated
- **Roof Thickness:** 40mm Insulated Sandwich Panel
- **PVCu Colour:** White as standard
- **Door Material:** Reinforced 5 Chamber PVCu Profile
- **Door Locking System:** 12 Point Locking System
- **Door Opening Size:** 1.34m x 1.85m (4' 4" x 6' 0")
- **Window Opening Size:** 0.93m x 0.61m (3' 0" x 2' 0")
- **Window Locking System:** Multi Point Espagnolettes
- **Glazing Material:** 28mm Double Glazed, Toughened Glass