

Dominator Composite Pent Garden Office

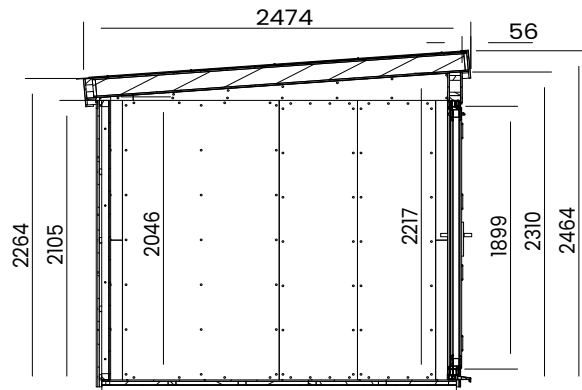
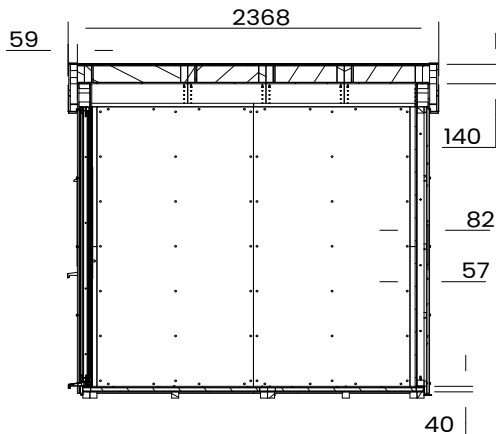
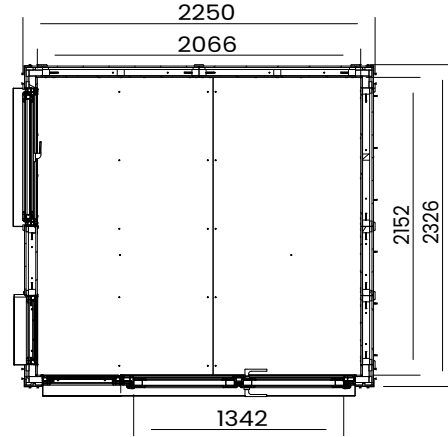

Specification

- Overall External Dimensions: W2.37m x D2.47m (7' 9.25" x 8' 1.5")
- External Width: 2.25m (7' 4.5")
- External Depth: 2.33m (7' 7.5")
- Internal Width: 2.07m (6' 9.25")
- Internal Depth: 2.15m (7' 0.75")
- Internal Area (m²): 4.45m²
- Internal Eaves (Rear): 2.05m (6' 9")
- Internal Eaves (Front): 2.22m (7' 3")
- Ridge Height: 2.46m (8' 1")
- Roof Thickness: 140mm
- Wall Thickness: 83mm
- Floor Thickness: 40mm
- Framing: 45mm
- Walls: 100% Slow Grown Spruce
- Floor Bearers: Pressure Treated for Longevity

- Door Walkthrough Height: 1.85m (6' 1")
- Door Walkthrough Width: 1.34m (4' 5")
- Door Locking System: Industry Leading 6 Point Lock - 2 Cams, Latch & Hook Bolt, 2 Shootbolts
- Approx DIY Assembly Time: 2 Days* *This is an approximate time only, based on 2 people. Assembly time may vary depending on season/weather conditions, foundation type, ability of those constructing, etc