

# Dominator Classic Garden Office

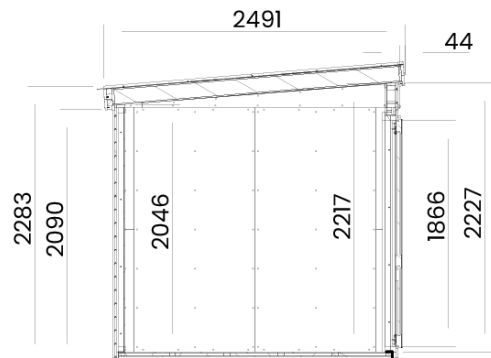
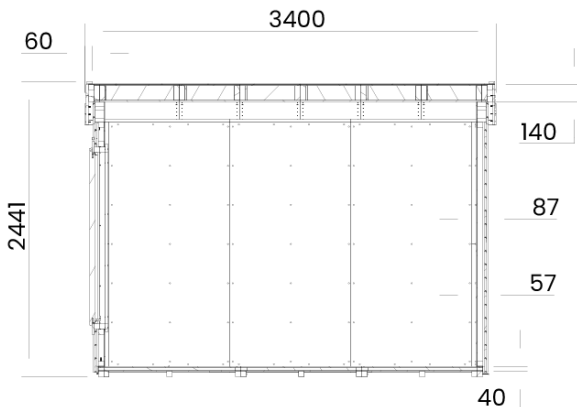
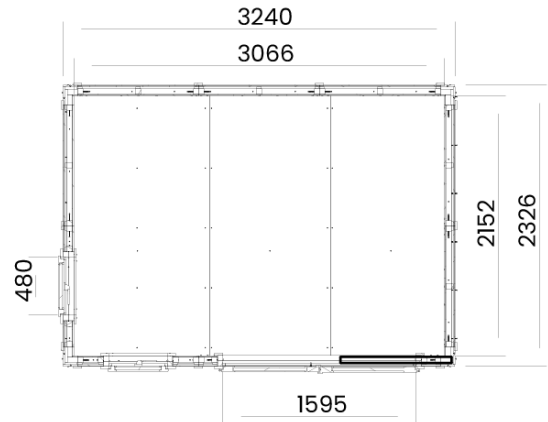

## Specification

- Overall External Dimensions: 2.49m x 3.40m x (8' 2" x 11' 1.75")
- External Width: 2.33m (7' 7.5")
- External Depth: 3.24m (10' 7.5")
- Internal Width: 2.15m (7' 0.75")
- Internal Depth: 3.07m (10' 0.75")
- Internal Area (m<sup>2</sup>): 6.60m<sup>2</sup>
- Internal Eaves (Front): 2.22 (7' 3.25")
- Internal Eaves (Rear): 2.05 (6' 8.5")
- Ridge Height: 2.48m (8' 1.75")
- Roof Thickness: 140mm
- Overall Wall Thickness: 87mm
- Floor Thickness: 40mm
- Framing: 45mm
- Walls: 100% Slow Grown Spruce
- Floor Bearers: Pressure Treated for Longevity

- Door Walkthrough Height: 1.87m (6' 1.5")
- Door Walkthrough Width: 1.60m (5' 2.75")
- Door Locking System: MultiPoint Locking System
- Approx DIY Assembly Time: 2 Days\* \*This is an approximate time only, based on 2 people. Assembly time may vary depending on season/weather conditions, foundation type, ability of those constructing, etc